

AF400 ... AF750 3-pole contactors

200 to 400 kW

AC / DC operated with 1 N.O. + 1 N.C. auxiliary contacts



AF460-30-11

1SFC101025V0001



AF750-30-11

1SFC101025V0001

Description

AF400 ... AF750 contactors are mainly used for controlling 3-phase motors and power circuits up to 1000 V AC or 600 V DC (2). These contactors are of the block type design with 3 main poles.

- control circuit: AC or DC operated with electronic coil interface accepting a wide control voltage range (e.g. 100...250 V AC and DC), only 4 coils to cover control voltages between 48...500 V 50/60 Hz and 24...500 V DC
- can manage large control voltage variations
- reduced panel energy consumption
- very distinct closing and opening
- can withstand short voltage dips and voltages sags (SEMI F47 conditions of use on request).
- built-in surge suppression
- add-on auxiliary contact blocks for side mounting and a wide range of accessories.

Ordering details

IEC	Rated operational power 400 V AC-3 kW	Rated operational current $\theta \leq 40^\circ\text{C}$ 690 V AC-1 A	UL/CSA 3-phase motor rating 480 V hp	General use rating 600 V AC A	Rated control circuit voltage Uc min. ... Uc max.		Auxiliary contacts fitted	Type	Order code	Weight kg
					V 50/60 Hz	V DC				
200	600	350	550	-	24...60	24...60	1 1	AF400-30-11	1SFL577001R6811 (1)	12.000
					48...130	48...130	1 1	AF400-30-11	1SFL577001R6911	12.000
					100...250	100...250	1 1	AF400-30-11	1SFL577001R7011	12.000
					250...500	250...500	1 1	AF400-30-11	1SFL577001R7111	12.000
250	700	400	650	-	24...60	24...60	1 1	AF460-30-11	1SFL597001R6811 (1)	12.000
					48...130	48...130	1 1	AF460-30-11	1SFL597001R6911	12.000
					100...250	100...250	1 1	AF460-30-11	1SFL597001R7011	12.000
					250...500	250...500	1 1	AF460-30-11	1SFL597001R7111	12.000
315	800	500	750	-	24...60	24...60	1 1	AF580-30-11	1SFL617001R6811 (1)	15.000
					48...130	48...130	1 1	AF580-30-11	1SFL617001R6911	15.000
					100...250	100...250	1 1	AF580-30-11	1SFL617001R7011	15.000
					250...500	250...500	1 1	AF580-30-11	1SFL617001R7111	15.000
400	1050	600	900	-	24...60	24...60	1 1	AF750-30-11	1SFL637001R6811 (1)	15.000
					48...130	48...130	1 1	AF750-30-11	1SFL637001R6911	15.000
					100...250	100...250	1 1	AF750-30-11	1SFL637001R7011	15.000
					250...500	250...500	1 1	AF750-30-11	1SFL637001R7111	15.000

(1) The connection polarities indicated close to the coil terminals must be respected: A1 for the positive pole and A2 for the negative pole.
 (2) Up to 850 V DC for AF580, AF750.

AF400 ... AF750 are equipped with low voltage inputs for control, for example by a PLC.

Control inputs

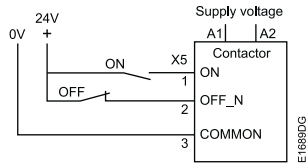

Main dimensions mm, inches

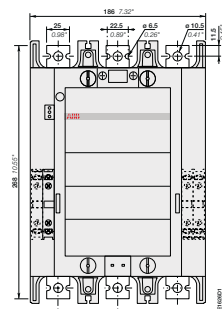

AF400, AF460

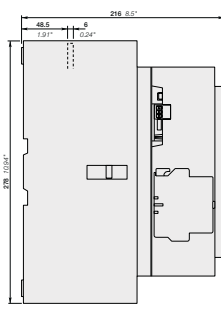

AF580, AF750